

ZA292L Inset Taxiway Edge

omni-directional inset light

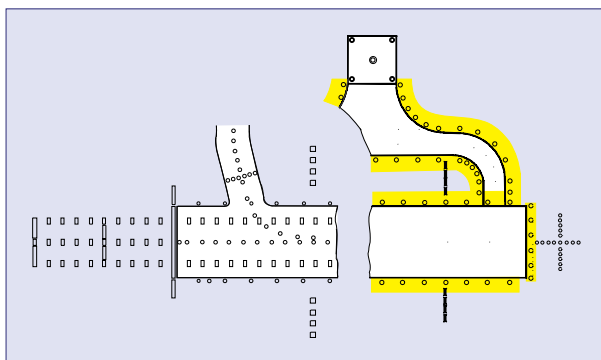

features

- **Body casting manufactured from aluminium alloy for lightness, strength and durability**
- **Long life High Brightness Emitting Diodes (objective life of 50000 hours at full brilliancy)**
- **Prism removal and replacement achieved without the need for adhesive or sealants**
- **3 hole body option for direct installation to SRA8/13 adaptor ring**
- **Lamp by-pass options available if required**
- **Suitable for direct installation in a ZM109, ZM181 or ZM203 IEC seating pot with only two point fixing**
- **Pre-focused optics to simplify maintenance procedures**
- **Low profile (10mm)**
- **Commonality of parts with the ZA181 and ZA280 inset fittings**
- **Light channel within 5mm of Grade**

compliance with standards

- **FAA** AC 150/5345-46C L-852T
- **ICAO** Annex 14 circular guidance 5.3.6, 5.3.9.8, 5.3.9.9
- **CAA** CAP168 Table 6A/1 Low intensity, taxiway edge
- **BS3224** Part 5, inset fittings
- **IEC** 61827
- **STANAG** 3316 Annex C fig 3

application

Low intensity, omni-directional inset fitting.

options

- ZM109 (8") seating pot SLC09035
- ZM181 seating pot (dry) SLC09085
- (wet) SLC09075
- ZM203 IEC SLC09112
- 12" and 15.5" PSA & FAA L868 canister adaptors.
- ZS023 sighting device SLC30021
- SRA8/13 adaptor.

electrical supply

Suitable for use in 6.6A airfield lighting circuits normally supplied from 1 x 30W, 45W, 65W or 100W isolating transformer. 120V and 240V mains supply versions also available. Power consumption with ZL836 Power Converter is 15 Watts/25VA.

Must be operated from atg airports ZL836 LED Interface.

packaging data

Net weight	3kg
Gross weight	3.5kg
Carton size	230mm (w) 230mm (d) 146mm (h)

components

- | | |
|---|---|
| <ul style="list-style-type: none"> 1 Body casting:
Anodise
Golden Yellow
NATO Green 2 Prism clamp 3 Prism clamp gasket 4 Prism gasket 5 Prism reflector 5a Cone | <ul style="list-style-type: none"> 6 LED Cluster 7 Not used 8 Not used 9 Bottom cover 10 Bottom cover gasket 11 Plug lead 12 Elkay gland set |
|---|---|

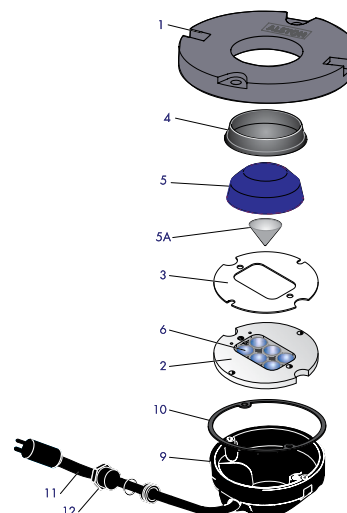

typical installation methods

- In ZM203 IEC seating pot - not shown SLC09112
 - In an FAA base can type L868
 - IEC body available
 - 3 hole body for SRA8/13 adaptor
- Installation onto an FAA L-868 seating canister is achieved by means of a suitable 12" or 15.5" adaptor.

L-852T-ZA292 and ZL836 Installed on FAA L-868 Base

1. ZA292 Fitting
2. 12" mounting adaptor
3. FAA L-868 base (one piece)
4. Outer earth terminal (optional)
5. Inner earth terminal (optional)
6. Isolating transformer
7. Secondary connection
8. Primary connection
9. Grommet
10. ZL836 Interface

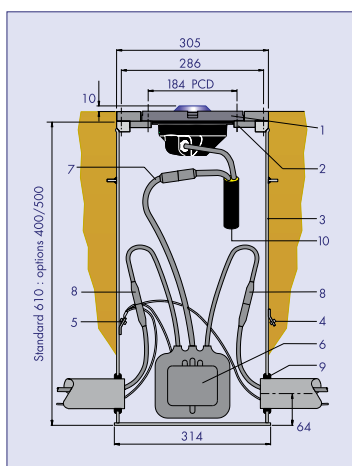

General arrangement

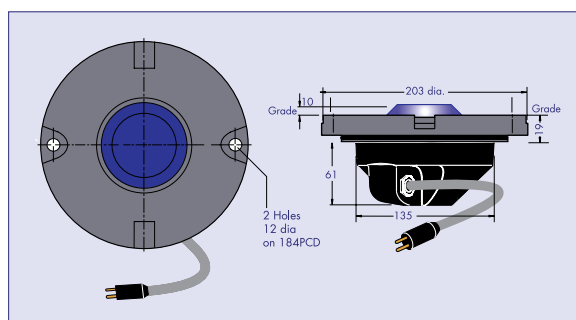

photometric performance

